

**DEEPPSEA**  
Power & Light®



# Nano SeaCam®

High Resolution. Compact. Durable.



## FEATURES

**Ultra Small & Compact Camera**

**Proprietary Optics**

**620 TVL Resolution**

**Up to 12km Depth Rated**

**Operates in Air and Water**

**Wide Angle with CCD Reliability**

T: (858) 576-1261  
F: (858) 576-0219

4033 Ruffin Road  
San Diego, CA  
92123- 1817 USA

[www.deepsea.com](http://www.deepsea.com)  
[sales@deepsea.com](mailto:sales@deepsea.com)



# Nano SeaCam®

## Standard Connector

### MCBH4MP



- 1 = Ground
- 2 = Power
- 3 = Video Out
- 4 = Not Used

\*12 km rated is only available w/ Subconn BH4MP connector.

## Dimensions

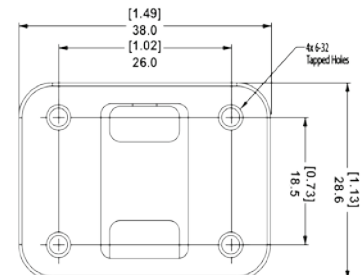
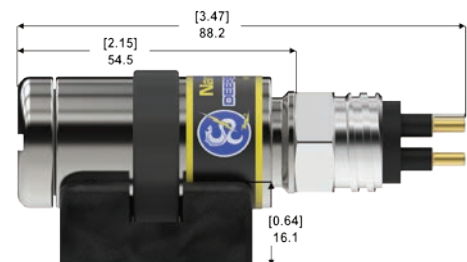
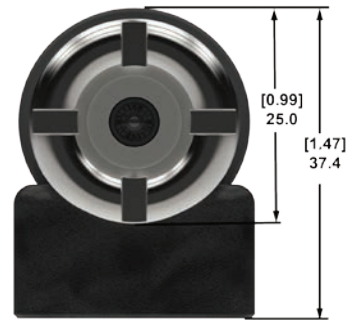

[inch]  
mm

Mechanical Specifications	
Housing	6Al-4V Titanium
Port	Optically Polished Sapphire
Outer Diameter	25.0 mm (0.99 in)
Overall Length (w/o connector)	54.5 mm (2.15 in)
Weight in Air	123.5 g (4.36 oz)
Weight in Water	105.34 g (3.71 oz)
Environmental Specifications	
Depth Rating	6km (19,685 ft) Standard 12km (39,370 ft) w/ Subconn BH4MP connector
Operating Temperature	-10° C to 50° C (14° F to 122° F)
Optical Specifications	
Lens	2.54 mm Fixed Focus (Proprietary Optics)
Depth of Field	75mm (3.0 in) to infinity
FOV in Air	80° (H) x 60° (V) x 102° (D)
FOV in Water	59° (H) x 44° (V) x 72° (D)
Video Specifications	
Image Sensor	1/3 inch SONY color CCD II 410K
Effective Pixel	NTSC: 768(H) x 494(V) PAL: 752(H) x 528(V)
Horizontal Resolution	620 TVL
Sensor Illumination	0.04 Lux
Signal to Noise	More than 50dB
Video Output	Composite 1.0Vp-p 75ohm unbalanced
Video Format	NTSC or PAL
Electrical Specifications	
Input Voltage Range	7-32V DC
Power Consumption	1W max



T: (858) 576-1261  
F: (858) 576-0219

4033 Ruffin Road  
San Diego, CA  
92123-1817 USA

www.deepsea.com  
sales@deepsea.com

