

DEESEA
Power & Light®



LED Matrix® - 3R SeaLite®

Puts the Light Where the you Need it the Most



FEATURES

6000 m Depth Rated

Remote Driver with up to 3 Light Heads

Light Output 40% Greater than 400W HMI

Super Rugged, Resistant to Shock and Vibration

Operates in Air or Water

Virtually Zero Maintenance

T: (858) 576-1261
F: (858) 576-0219

4033 Ruffin Road
San Diego, CA
92123- 1817 USA

www.deepsea.com
sales@deepsea.com



LED Matrix® - 3R SeaLite®

Mechanical Specifications

Body Material	Hard Anodized Aluminum (7075)
Window Material	Sapphire
Mounts	High Strength Stainless Steel Yoke (standard)
Weight of Ballast	Air: 3.49 kg (7.7 lbs) Water: 1.53 kg (3.38 lbs)
Weight of Light Head	Air: 0.35 kg (0.8 lbs) Water: 0.23 kg (0.5 lbs)
Implodible Volume of the Ballast	737.42 cm ³ (45 in ³)

Environmental Specifications

Depth Rating	6000 m (20,000 ft)
Test Pressure	10,000 psi
Operation Temp.	10° C to 40° C (14° F to 104° F)

Optical Specifications

Color	Red, White, Blue
Lumens in the Water	18,000 Lumens Typical (measured with all 3 light-heads on)
Color Temp	6900° K (white LED)
Beam Pattern (FWHP)	Flood: 77° / Medium: 30°

Electrical Specifications

Input	85 - 150V AC @ 50/60Hz, 75-200V DC, 375W max or 150V AC - 250V AC @ 50/60Hz, 200-300V DC, 375W max
Dimming	AC phase control dimmer

Standard Connector



BH3MP

- 1 = Hot (DC+)
- 2 = Neutral (DC -)
- 3 = Chassis

*Other connectors and pin-out options are available upon request.

Dimensions

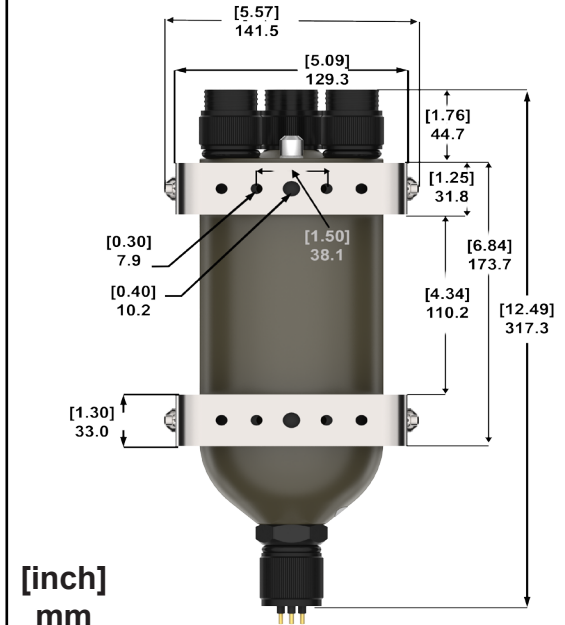
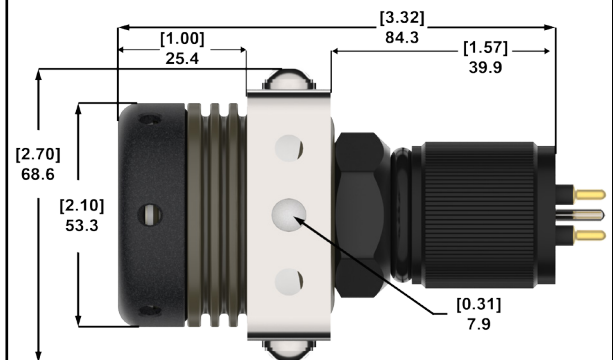

4033 Ruffin Road
San Diego, CA
92123-1817 USA

www.deepsea.com
sales@deepsea.com



T: (858) 576-1261
F: (858) 576-0219